

EXT. DOOR SCHEDULE

REF	SIZE(WxH)/NOTES
1	1030x2100 (PART M ACCESS)
2	1030x2100 (PART M ACCESS)
3	1810x2100 (MIN 850mm CLEAR LEAF & SAFETY GLAZING)

REFER TO ELEVATIONS FOR DOOR STYLES.

INT. DOOR SCHEDULE

REF	SIZE(WxH)/NOTES
4	838x1981
5	838x1981
6	838x1981
7	762x1981
8	838x1981
9	838x1981
10	762x1981
11	762x1981
12	762x1981
13	762x1981
14	762x1981
15	762x1981

DOOR STYLES TO CLIENT SELECTION.

WINDOW SCHEDULE

REF	SIZE(WxH)/NOTES
1	1340/562x1350 (BAY WINDOW)
2	1340/562x1350 (BAY WINDOW)
3	1810x1050
4	556x900
5	1248x1200 (FIRE ESCAPE)
6	630x1050 (OBSCURE)
7	1248x1200 (FIRE ESCAPE)
8	1135x1050 (OBSCURE)
9	1135x1200
10	1135x1200 (FIRE ESCAPE)

REFER TO ELEVATIONS FOR OPENINGS AND WINDOW STYLES.

LEGEND/NOTES:

- BRICKWORK
- NON-LOADBEARING BLOCKWORK
- LOAD-BEARING BLOCKWORK
- INSULATED STUDWORK PARTITION
- BEAM/LINTEL/TRIMMER/GIRDER TRUSS OVER
- DENOTES SPAN OF BEAM & BLOCK FLOOR BELOW
- DENOTES SPAN OF ROOF TRUSSES ABOVE
- CONSUMER UNIT
- SMOKE DETECTOR (PRECISE LOCATION TO BE DETERMINED BY M&E DESIGN)
- HEAT DETECTOR (PRECISE LOCATION TO BE DETERMINED BY M&E DESIGN)
- MECHANICAL EXTRACT FAN (PRECISE LOCATION TO BE DETERMINED BY M&E DESIGN)
- AIR SOURCE HEAT PUMP LOCATION
- DIRECT DRAINAGE POINT
- SOIL AND VENT PIPE
- FLOOR SOCKET
- DRAINAGE WASTE PIPES
- PLY LINED PARTITION
- SECTION LOCATION MARKS
- DOOR REFERENCE
- WINDOW REFERENCE

- ALL DIMENSIONS ARE GIVEN IN MILLIMETRES UNLESS OTHERWISE NOTED.
- DO NOT SCALE FROM THESE DRAWINGS, WORK FROM FIGURED DIMENSIONS ONLY.
- ALL DIMENSIONS ARE TO BE CHECKED ON SITE BY THE CONTRACTOR/FABRICATOR PRIOR TO COMMENCEMENT OF CONSTRUCTION/FABRICATION.
- DRAWINGS TO BE READ IN CONJUNCTION WITH 'SUPPLEMENTARY NOTES REGARDING BUILDING REGULATIONS'.
- DRAWINGS TO BE READ IN CONJUNCTION WITH STRUCTURAL ENGINEERS DESIGN AND SPECIFICATION.
- ANY DISCREPANCIES IN DIMENSIONS OR NOTES ARE TO BE REPORTED TO THE ARCHITECT, ALSO PRIOR TO COMMENCEMENT OF CONSTRUCTION/FABRICATION.
- WHEN APPLICABLE REFER TO LARGE SCALE DRAWINGS AND SPECIFICATION OF MATERIALS AND WORKMANSHIP.

- STRUCTURAL DESIGN NOTES:
- REFER TO STRUCTURAL DESIGN BY 'ROSSILONG' FOR FULL DETAILS (REF: 231278_S-113_P05) DATED 25/06/2024.
 - ALL BLOCKWORK IS TO BE MINIMUM 3.6N/mm² COMPRESSIVE STRENGTH UNLESS NOTED OTHERWISE.
 - ALL CAVITY WALLS ARE TO HAVE STAINLESS STEEL WALL TIES AT 900mm CENTRES HORIZONTALLY AND 450mm CENTRES VERTICALLY. TIES ARE TO BE AT 225mm CENTRES VERTICALLY ADJACENT TO ALL OPENINGS AND MOVEMENT JOINTS.
 - ALL LINTELS BY BIRTLEY LINO AND ARE TO HAVE A MINIMUM OF 150mm END BEARINGS.
 - LATERAL RESTRAINT STRAPS ARE TO BE PROVIDED TO ALL EXTERNAL WALLS AT A MAXIMUM SPACING OF 1.5m.
 - WALL PLATES ARE TO BE FIXED DOWN TO WALLS USING PROPRIETARY GALVANISED STEEL STRAPS AT A MAXIMUM OF 1.25m CENTRES.

- STRUCTURAL DESIGN LEGEND:
- M/J MOVEMENT JOINT
 - BEAM / LINTEL / TRIMMER / GIRDER TRUSS OVER
 - 9mm OSB SHEATHING

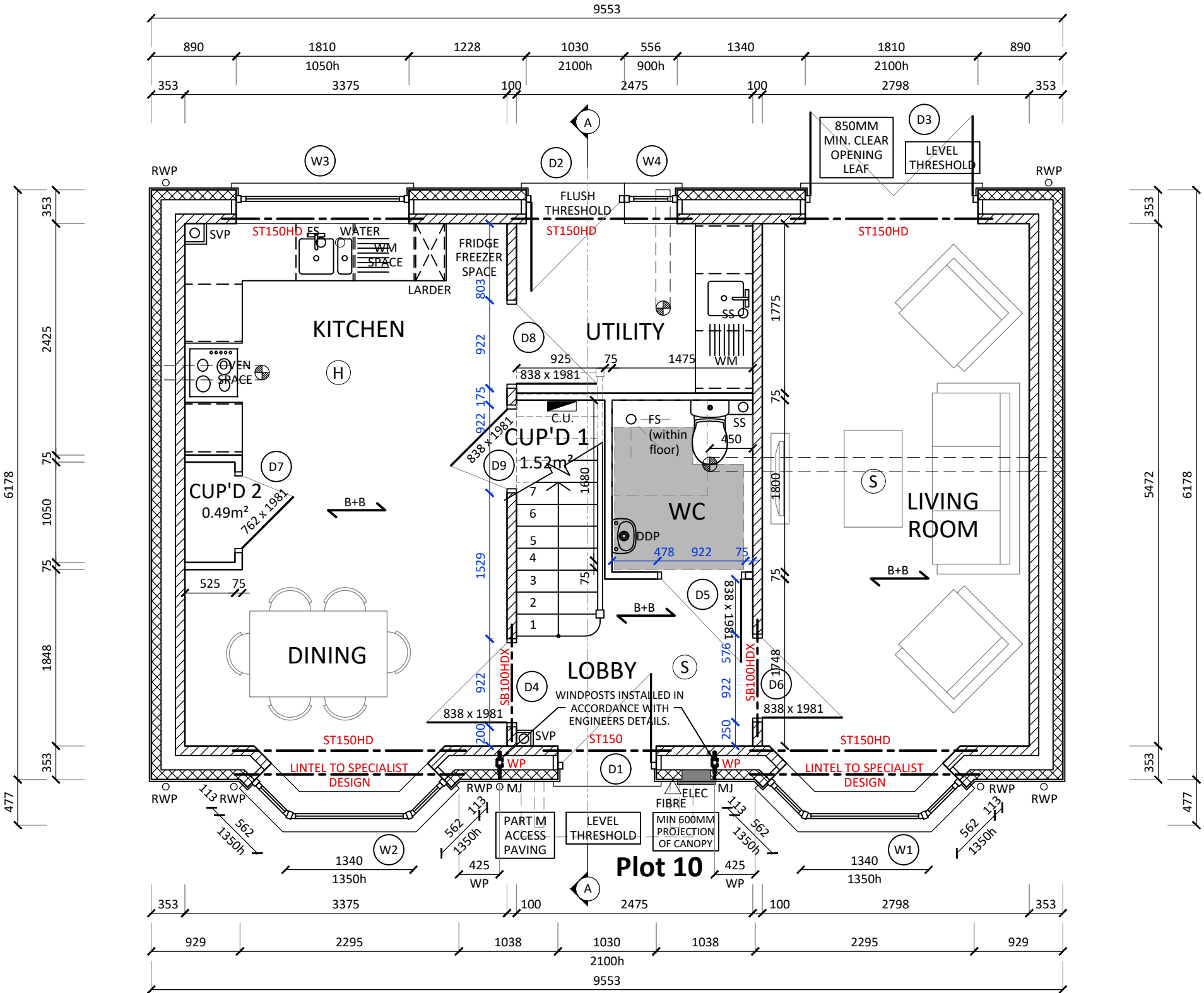

GROUND FLOOR PLAN
GIA 98.3m²

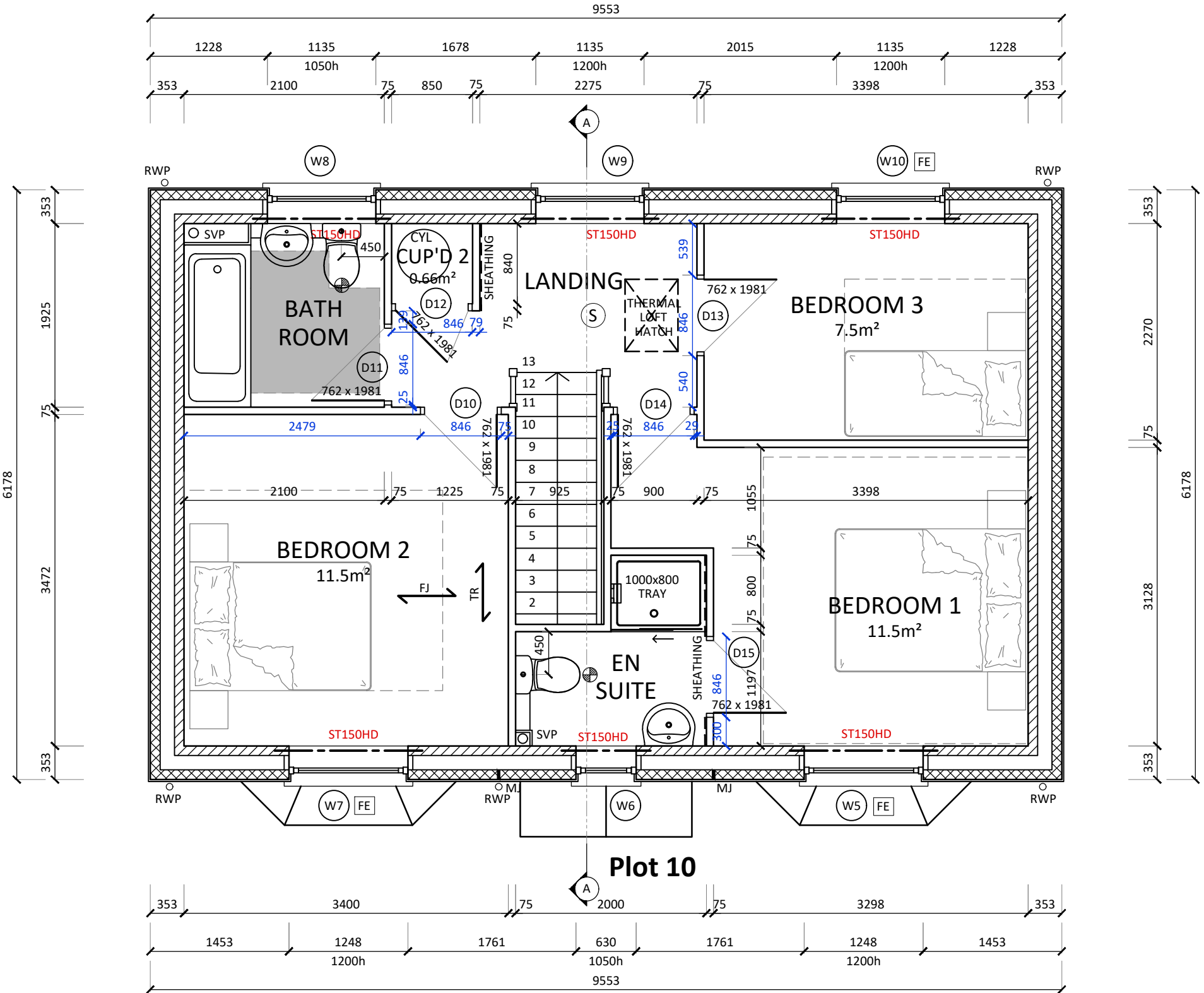

FIRST FLOOR PLAN

- Rev.
- C. Kitchen details updated. 29.07.24
 - B. Updated to structural engineers details. 27.06.24
 - A. Updated to structural engineers details. 22.05.24



CLIENT	Eastlight Community Homes Limited
PROJECT	Whatfield Road, Elmsett, Ipswich, Suffolk
DRAWING TITLE	TYPE D FLOOR PLANS NDSS COMPLIANT
PURPOSE OF ISSUE	BUILDING REGULATIONS
JOB NO.	L335
DATE	06.07.23
SCALES	1:50
DRAWN BY	M.R.
CHECKED BY	J.F.
DWG NO.	L335/H.209C
SHEET NO.	1 OF 3
© Copyright Rose Builders Limited	